

Accurate Die Design Confirms Results

Accurate Die Design, in New Berlin, WI, USA has over 40 years of combined experience in progressive, transfer draw, and fineblank die design. They provide accurate and robust die designs, from a diemaker's perspective, that balance maximum die up time with economy. FTI had, a chance recently, to interview Ray Proeber, President.



Automotive motor mount bracket

"A few years ago, unfolding true 3D parts using special software was very expensive. The software to do this cost well over \$10,000, annually and the learning curve was such that you needed someone who had a good deal of time to learn to use it. This left most of us behind, forced to use the same old crude methods of either a wild guess or some form of rough development", says Proeber.

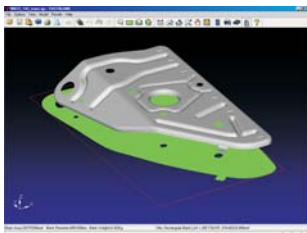

FASTBLANK depicts part and blank

"Several months ago, I used FTI's FastBlank software for the first time and was shocked by how accurate and affordable it was," adds Proeber. "I was even more surprised to find that, with no training whatsoever, I was getting results from the product within an hour of downloading it."

"I know firsthand how skeptical tool makers and designers can be, so we've started to compile real life examples from actual dies that we've designed - comparing the FTI predicted blank to the actual blank that the production die ends up producing."

"The results have been remarkably close. Estimated blank results have been within anywhere from .000 to .010" of the actual blank", states Proeber. The software also predicts metal thinning and gatering, which is extremely valuable information when designing a tool. Having this type of knowledge upfront substantially reduces development time and avoids future problems.



Washed out area is indicated by black arrow

"I will continue with my testing since I know that there is no such thing as having too much evidence for some tool and die makers, designers and estimators. It's one of those technologies that have come upon us so quickly; we have to see it to believe it."

FASTBLANK is now available standalone, or integrated with SolidWorks or Solid Edge. The free 14 day trial download makes it easy for anyone to evaluate for them-selves how accurate and easy to use it is. Please visit Accurate Die Design at www accuratediedesign.com

